

▶ Jaw Changing System



IMP210

IMS210

IMP310

IMS310



Pulverzer Jaw



Demolition Jaw



Shear Jaw

Model	Unit	IMS210	IMP210	IMD210	IMS310	IMP310	IMD310
Operating weight	kg	1,895	2,000	2,000	2,600	2,630	2,630
	lb	4,177	4,409	4,409	5,732	5,798	5,798
Overall Length	mm	2,148	2,234	2,321	2,245	2,627	2,529
	inch	84.56	87.95	91.37	88.39	103.43	99.57
Overall Width	mm	1,182	1,354	1,354	1,254	1,443	1,213
	inch	46.54	53.31	53.31	45.37	56.81	47.56
Max. Opening Width	mm	520	880	645	542	957	731
	inch	20.47	34.65	25.39	21.34	37.68	28.78
Cutter Length	mm	120 x 4ea	200	400	120 x 4ea	300	500
	inch	4.72 x 4ea	7.87	15.74	4.72 x 4ea	11.81	19.69
Crushing Force & Cutting Force	ton(A)	63	53	61	85	73	82
	ton(B)	87	72	172	115	102	134
	ton(C)	108	97	256	142	134	229
	ton(D)	172	145		217	201	
	ton(E)		165			229	
Operating pressure	kg/cm ²	300			320		
	psi	4,226			4,550		
Oil Flow Rate	LPM	200~250			250~300		
	GPM	52.8~66.1			66.1~79.2		
Suitable Excavator	ton	18~26			26~32		
Speed Up Valve					Option		
Motor setting	kg/cm ²				160		
Pressure	psi				2,275		
Motor Oil Flow Rate	LPM				36~40		
	GPM				9.5~10.5		
Revolving Speed	RPM				13~15		

HYDRAULIC BREAKER ATTACHMENT CRUSHER



ICM International Construction Machinery

ICM Heavy Industries Co., Ltd.

Head Office : 143-1 Haechang-ri Paltan-myun, Hwaseong-si Gyeonggi-do, Korea

TEL : -82-31-353-4205 FAX : -82-31-353-5720

E-mail : cheong@icm-tool.com

steven@icm-tool.com

www.ICM-TOOL.com

ICM
International Construction Machinery



ICM “V-Type” Breaker Series

- Ready to work under any working sites!
- High quality & pround durability!
- Priority system for customer satisfaction!



► Specification

OUT WARD TYPE	Unit	IB 180FV	IB 200FV	IB 300FV	IB 400FV
Selection of Machine	ton	13-18	18-22	27-30	35-45
	lb	28680-39683	39683-48501	59524-66138	77161-99208
Operation Weight	kg	1230	1740	2420	3020
	lb	2706	3828	5324	6644
Weight of Main Body	kg	510	750	950	1400
	lb	1030	1515	1919	2828
Height(Incl. Tool)	mm	2031	2327	2500	2950
	inch	81	93	100	118
Required oil Flow Range	l/min	90-120	130-150	150-190	190-250
	gal/min	24-32	34-40	40-77	77-
Operating Pressure	bar	160-180	160-180	160-180	160-180
	psi	2276-2560	2276-2560	2276-2560	2276-2560
Impact Rate	bpm	400-900	400-800	350-750	250-500
	mm	120	135	150	160
Rod / Chisel	inch	4,724	5,315	5,905	6,299
	mm	ø 19	ø 25	ø 25	ø 32
Hose Diameter	inch	3/4	1	1	1 1/4
	kg.m	286	366	714	1010
Impact Energy Class	joule	2800	3588	7000	9900
	ft.lb	2065	2647	5163	7302
Back Head Gas Pressure	bar(psi)	6(87)	6(87)	6(87)	6(87)

※ Specifications and features are subject to change without prior to better improvement in quality

► Specification

IN WARD TYPE	Unit	IB 100V	IB 200V	IB 300V	IB 400V	IB 430V	IB 450V	IB 500V	IB 600V	IB 700V	IB 800V	IB 1000V	IB 1200V	IB 1300V	IB 1500V
Selection of Machine	ton	0,8-2,5	1,2-3,0	2,5-4,5	4,0-7,0	6-9	7-14	11-16	15-18	18-21	18-26	25-30	28-35	30-40	40-55
	lb	1763-5511	2645-6613	5511-9920	9920-15432	13227-19841	15432-30864	24250-35274	33069-39683	39683-46297	39683-57320	55115-66138	61729-77161	66138-88185	88185-121154
Operation Weight	kg	72	92	150	275	295	500	795	1250	1450	1780	2100	2700	2995	4100
	lb	158	202	330	605	649	1100	1749	2750	3190	3916	4620	5940	6589	9020
Weight of Main Body	kg	53	65	86	151	210	280	471	652	754	911	1072	1283	1443	1924
	lb	107	131	174	305	424	566	951	1317	1523	1840	2165	2592	2915	3886
Height(Incl. Tool)	mm	1135	1262	1342	1600	1860	2101	2326	2604	2691	2828	3055	3255	3395	3709
	inch	45	50	53	63	73	83	92	103	1106	111	120	128	134	146
Required oil Flow Range	l/min	15-25	20-30	25-50	40-70	50-90	60-100	80-110	90-120	100-150	120-180	150-210	180-240	200-260	210-290
	gal/min	4-8	5-10,5	6,5-13	10,5-18,5	13-24	16-16,5	21-29	24-32	27-40	32-48	40-56	48-63	51-69	55-77
Operating Pressure	bar	90-120	90-120	90-120	110-140	120-150	130-160	150-170	150-170	160-180	160-180	160-180	160-180	160-180	160-180
	psi	1280-1707	1280-1707	1280-1707	1565-1991	1707-2134	1849-2276	2134-2418	2134-2418	2276-2560	2276-2560	2276-2560	2276-2560	2276-2560	2276-2560
Impact Rate	bpm	800-1400	700-1200	600-1100	500-900	400-800	400-800	350-700	350-650	350-600	350-500	300-450	300-450	250-400	200-350
	mm	40	45	53	68	75	85	100	125	135	140	150	155	155	175
Rod / Chisel	inch	1,57	1,811	2,087	2,677	2,953	3,346	3,937	4,921	5,315	5,511	5,905	6,102	6,102	6,889
	mm	ø 12	ø 12	ø 12	ø 12	ø 12	ø 19	ø 19	ø 25	ø 25	ø 25	ø 25	ø 32	ø 32	ø 32
Hose Diameter	inch	1/2	1/2	1/2	1/2	1/2	3/4	3/4	1	1	1	1	1 1/4	1 1/4	1 1/4
	kg.m	21	30	33	70	92	133	214	296	363	429	531	663	918	1224
Impact Energy Class	joule	203	290	320	690	900	1300	2100	2900	3555	4200	5200	6500	9000	12000
	ft.lb	150	214	236	509	664	959	1549	2139	2622	3098	3836	4794	6638	8851
Back Head Gas Pressure	bar(psi)	16(232)	16(232)	16(232)	16(232)	16(232)	16(232)	16(232)	16(232)	16(232)	16(232)	16(232)	16(232)	16(232)	16(232)

※ Specifications and features are subject to change without prior to better improvement in quality



ICM “S-Type” Breaker Series

- Noise reduction technology!
- Friendly environment!
- High quality & proud of durability!



► Specification

OUT WARD TYPE	Unit	IB 180FS	IB 200FS	IB 300FS	IB 400FS
Selection of Machine	ton	13-18	18-22	27-30	35-45
	lb	28680-39683	39683-48501	59524-66138	77161-99208
Operation Weight	kg	1310	1840	2540	3110
	lb	2888	4066	5600	6834
Weight of Main Body	kg	510	750	950	1400
	lb	10302031	1515	1919	2828
Height(Incl. Tool)	mm	81	2327	2500	2950
	inch	90-120	93	100	118
Required oil Flow Range	l/min		130-150	150-190	190-250
	gal/min	24-32	34-40	40-77	77-65
Operating Pressure	bar	160-180	160-180	160-180	160-180
	psi	2276-2560	2276-2560	2276-2560	2276-2560
Impact Rate	bpm	400-900	400-800	350-750	250-550
	mm	120	135	150	160
Rod / Chisel	inch	4.724	5.315	5.905	6.299
	mm	ø 19	ø 25	ø 25	ø 32
Hose Diameter	inch	3/4	1	1	1 1/4
	kg.m	286	366	714	1010
Impact Energy Class	joule	2800	3588	7000	9900
	ft_lb	2065	2647	5163	7302
Back Head Gas Pressure	bar(psi)	6(87)	6(87)	6(87)	6(87)

※Specifications and features are subject to change without prior to better improvement in quality

► Specification

IN WARD TYPE	Unit	IB 100S	IB 200S	IB 300S	IB 400S	IB 430S	IB 450S	IB 500S	IB 600S	IB 700S	IB 800S	IB 1000S	IB 1200S	IB 1300S	IB 1500S
Selection of Machine	ton	0.8-2.5	1.2-3.0	2.5-4.5	4.0-7.0	6-9	7-14	11-16	15-18	18-21	18-26	25-30	28-35	30-40	40-55
	lb	1763-5511	2645-6613	5511-9920	9920-15432	13227-19841	15432-30864	24250-35274	33069-39683	39683-46297	39683-57320	55115-66138	61729-77161	66138-88185	88185-121154
Operation Weight	kg	102	126	152	295	375	571	861	1296	1500	1825	2071	2635	2850	3990
	lb	225	278	335	650	827	1259	1898	2857	3306	4023	4565	5809	6283	8796
Weight of Main Body	kg	53	65	86	151	210	280	471	652	754	911	1072	1283	1443	1924
	lb	107	131	174	305	424	566	951	1317	1523	1840	2165	2592	2915	3886
Height(Incl. Tool)	mm	1135	1262	1342	1600	1860	2101	2326	2604	2691	2828	3055	3255	3395	3709
	inch	45	50	53	63	73	83	92	103	1106	111	120	128	134	146
Required oil Flow Range	l/min	15-25	20-30	25-50	40-70	50-90	60-100	80-110	90-120	100-150	120-180	150-210	180-240	200-260	210-290
	gal/min	4-8	5-10.5	6.5-13	10.5-18.5	13-24	16-16.5	21-29	24-32	27-40	32-48	40-56	48-63	51-69	55-77
Operating Pressure	bar	90-120	90-120	90-120	110-140	120-150	130-160	150-170	150-170	160-180	160-180	160-180	160-180	160-180	160-180
	psi	1280-1707	1280-1707	1280-1707	1565-1991	1707-2134	1849-2276	2134-2418	2134-2418	2276-2560	2276-2560	2276-2560	2276-2560	2276-2560	2276-2560
Impact Rate	bpm	800-1400	700-1200	600-1100	500-900	400-800	400-800	350-700	350-650	350-600	350-500	300-450	300-450	250-400	200-350
	mm	40	45	53	68	75	85	100	125	135	140	155	155	155	175
Rod / Chisel	inch	1.57	1.811	2.087	2.677	2.953	3.346	3.937	4.921	5.315	5.511	5.905	6.102	6.102	6.889
	mm	ø 12	ø 12	ø 12	ø 12	ø 12	ø 19	ø 19	ø 25	ø 25	ø 25	ø 25	ø 32	ø 32	ø 32
Hose Diameter	inch	1/2	1/2	1/2	1/2	1/2	3/4	3/4	1	1	1	1	1 1/4	1 1/4	1 1/4
	kg.m	21	30	33	70	92	133	214	296	363	429	531	663	918	1224
Impact Energy Class	joule	203	290	320	690	900	1300	2100	2900	3555	4200	5200	6500	9000	12000
	ft_lb	150	214	236	509	664	959	1549	2139	2622	3098	3836	4794	6638	8851
Back Head Gas Pressure	bar(psi)	16(232)	16(232)	16(232)	16(232)	16(232)	16(232)	16(232)	16(232)	16(232)	16(232)	16(232)	16(232)	16(232)	16(232)

※Specifications and features are subject to change without prior to better improvement in quality

ICM “SL, BL-Type” Breaker Series

- Advanced technology!
- Excellent performance!
- Easier and faster maintenance!



► Specification

OUT WARD TYPE	Unit	IB 300SL	IB 400SL	IB 400BL	IB 430BL	IB 450BL
Selection of Machine	ton	2,5-4,5	4-7	4-7	6-9	7-14
	lb	5511-9920	9920-15432	9920-15432	13227-19841	15432-30864
Operation Weight	kg	180	430	270	400	550
	lb	396	948	545	808	1111
Weight of Main Body	kg	86	151	151	210	280
	lb	174	305	305	424	566
Height(Incl. Tool)	mm	1300	1500	1347	1518	1737
	inch	52	59	53	60	68
Required oil Flow Range	l/min	25-50	40-70	40-70	50-90	60-100
	gal/min	6,5-13	10,5-18,5	10,5-18,5	13-24	16-16,5
Operating Pressure	bar	90-120	110-140	110-140	120-150	130-160
	psi	1280-1707	1565-1991	1565-1991	1707-2134	1849-2276
Impact Rate	bpm	600-1100	500-900	500-900	400-800	400-800
	mm	53	68	68	75	85
Rod / Chisel	inch	2,087	2,677	2,677	2,953	3,346
	mm	ø 12	ø 12	ø 12	ø 12	ø 19
Hose Diameter	inch	1/2	1/2	1/2	1/2	3/4
	kg.m	33	70	70	92	133
Impact Energy Class	joule	320	690	690	900	1300
	ft_lb	236	509	509	661	959
Back Head Gas Pressure	bar(psi)	16(232)	16	16(232)	16(232)	16(232)

※Specifications and features are subject to change without prior to better improvement in quality

Inward valve type

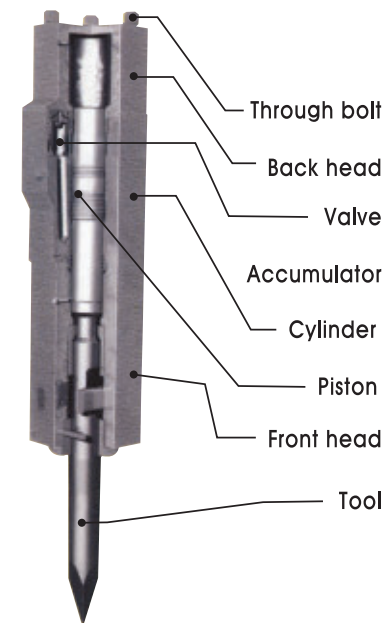

Reinforcement



Auto Grease System

Outward valve type

The longest service life due to applied heat treatment.

The energy of piston stroke is accumulated due to charged nitrogen gas.

As a valve system, easier and quicker repair and/or replacement.

As high pressure surge damper, it's for protecting pump output of base machine.

Easy and lowest maintenance cost due to minimized parts.

The dimension and special steel quality of piston exert longer service life.

The front cover can easily be replaced.

The working tool guarantees the performance and economy of JSB hydraulic breaker.

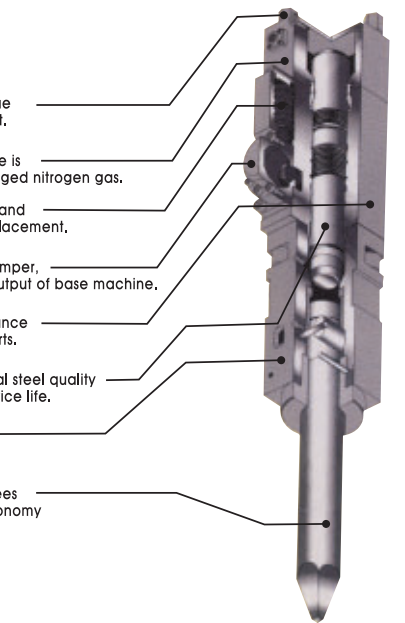

ICM TOTAL ATTACHMENT Series

- Best Work Efficiency!
- Simple & Easy maintenance!
- Excellent Durability!



Quick-Coupler



Benefits

- The strongest durability on the same class prolongs its life.
- Double safety device
- Shorten the working hours with fast removable coupler
- Enough room for the safety pin

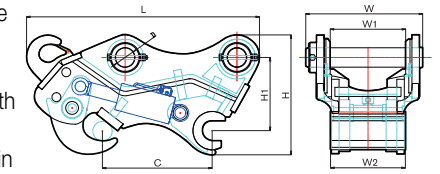

Standard	Unit	ISQ30	ISQ60	ISQ80	ISQ100	ISQ140	ISQ170	ISQ200
Operating Weight	kg	54~60	150~163	340	520	650	725	890
Length (L)	mm	575~593	814~820	970	1080	1125	1226	1285
Height (H)	mm	285	378	491	552	584	612	662
Width (W)	mm	249~259	408~423	469~503	543~593	574~624	630~670	680~710
Installation Width (W1)	mm	155~165	260~275	306~340	350~410	410~432	410~440	470~510

※ It can be changed for improving product's performance.

Fixed Stone Grapple / Waste Grapple

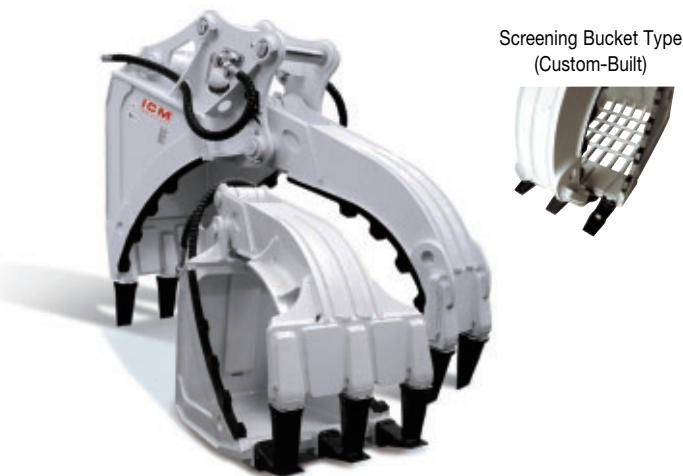

Benefits

- Handling of seawalls, stones and many others are all available.
- Multipurpose function to prevent slipping
- Available to work with many kinds of stone (Option)
- Available to classify soil cement and stone (Option)

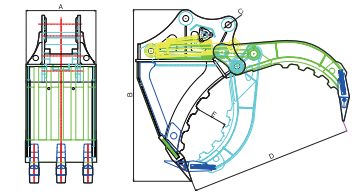

	Equipment Weight	A	B	C	D	E	Weight(kg)
ISG30	5~7	430	1112	45	1121	170	305
ISG60	12~15	636	1536	65	1458	276	730
ISG80	18~22	800	1849	70~80	1927	32	1430
ISG100	28~31	833	1976	80~90	2136	376	1860

※ It can be changed for improving product's performance.

Rotating Stone Grapple



Benefits

- Carrying rocks and excellent performance in loading
- Strong power and a crash-cushion on high pressure cylinder
- Excellent abrasion resistance and high gradient prolong its life
- Swing bearing shock absorber
- The safety check valve in cylinder prevents the grabbed material from falling down.

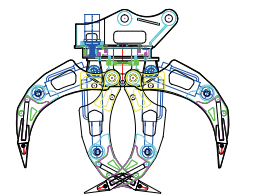

Class	Weight (kg)	Max Jaw Opening (kg)	Oil Pressure (kg/cm)	Carrier (ton)
IRSG30	365	1,290	120~190	4~7
IRSG60	850	1,700	150~200	11~16

※ It can be changed for improving product's performance.

Rotating Wood Grapple



Benefits

- Outstanding performance on loading at the logging place
- High use in various works
- During the swing work, it prevents the grabbed material from falling down by grabbing more safely even when the machine is stopped.

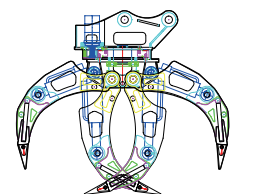

Class	Weight (kg)	Max Jaw Opening (kg)	Oil Pressure (kg/cm)	Carrier (ton)
IRWG30	365	1,290	120~190	4~7
IRWG60	850	1,700	150~200	11~16

※ It can be changed for improving product's performance.

ICM ATTACHMENT CRUSHER Series

- Strong Power!
- Perfect Performance!
- Outstanding Durability!

▶ Compactor



All-in-one block oil flow control valve



Proper high-quality oil pressure motor to all types of models

Benefits

- Proper high-quality oil pressure motor to all types of models
- All-in-one block oil flow control valve
- Highly effective in hardening the narrow ditch

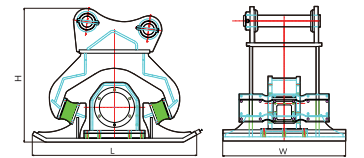

Model	Impulse Force (ton)	Hydraulic Flow (rpm)	Capacity (cc/rev)	Pressure (kg/cm ²)	Measurement (LXWXH)mm	Height (H)mm	Width (W)mm
ICT60	7	600-2,000	63	150-250	1,145×700×28	850	700
ICT80	15	600-2,000	80	150-250	1,250×850×30	1,100	850
ICT100	15	600-2,000	100	180-210	1,350×950×32	1,100	950

※ It can be changed for improving product's performance.

▶ Multi-Purpose Grapple



Benefits

- Can be used for various purposes in many work places
- Excellent work performance and convenient function
- Safety amount check valve
- A crash-cushion device
- Simplifying procedures of changing structure

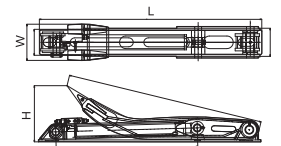

Class	Carrier	Weight	L(mm)	W(mm)	H(mm)
IPG30	4-7	110-140	1,255	235	353
IPG60	11-16	150-170	1,622	264	409

※ It can be changed for improving product's performance.

▶ Ripper



Benefits

- The flat board work is available.
- Large ripper tooth prevents it from breaking.
- High quality and strengthened performance

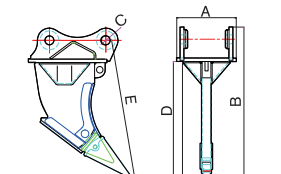

Model	Equipment Weight (ton)	A	B	C	D	E	Weight(kg)
IRP30	5-7	260-270	717	45	569	674	93
IRP60	12-15	398	1067	65	842	1010	275
IRP80	18-22	460-490	1167	70-80	894	1105	440
IRP100	28-31	530-590	1358	80-90	1046	1255	625
IRP140	34-38	610-530	1626	90-100	1259	1515	885
IRP170	39-43	620-650	1626	100-110	1259	1520	950
IRP200	45-50	660-720	1679	110-120	1270	1560	1065

※ It can be changed for improving product's performance.

▶ Bale Grapple



Benefits

- The highest performance on the same class
- The pressure of excavator makes it available to load/unload two-row.

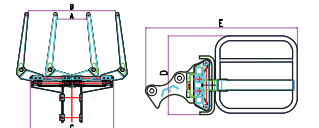

Model	Equipment Weight (ton)	A	B	C	D	E	Using Pressure	Weight (kg)
IBG30	5-7	515	1,530	1,460	996	1,920	40-180	280
IBG60	12-15	515	1,530	1,460	996	1,780	40-200	294

※ It can be changed for improving product's performance.

▶ Lifting Fork



Benefits

- Available to load/unload palletized materials such as building materials and bricks
- Low price and reliable quality
- Available to adjust distances of three-row

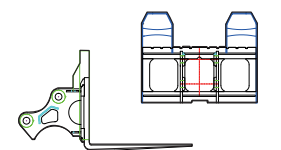

Model	Weight	Width (mm)	Fork Using Weight (kg)	Length (mm)	Carrier (ton)
ILF30	190	880	2,500	1,020	4-7
ILF60	235	948	2,500	1,070	11-16
ILF80	600	1,300	5,000	1,200	18-26
ILF100	1,100	1,650	7,000	1,200	29-35

※ It can be changed for improving product's performance.



▶ Bucket / Screening Bucket



Benefits

- Strengthen durability by using hardox special solid steel
- Cutting total expenses by reducing weight
- Fulfill customer satisfaction with order production for medium-large size

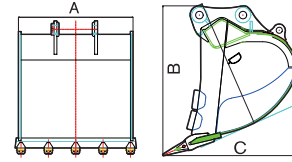

Model	Equipment Weight (ton)	A (mm)	B (mm)	C (mm)	D (mm)	Bucket Weight (kg)	Capacity (m ³)
IBK60	12-15	880	1,276	974	1030	450	0,5-0,7
IBK80	18-22	1,150	1,520	1,200	1300	950	0,7-0,9
IBK100	28-31	1,150	1,636	1,365	1425	1270	1,1-1,3
IBK140	34-38	1170	1,765	1,430	1534	1450	1,4-1,7
IBK170	39-43	1,290	1,870	1,660	1638	1820	1,7-1,9
IBK200	45-50	1,1590	1,934	1,730	1693	2600	2,0-2,3
IBK300	52-70	1,068	2,348	2,126	2123	3200	2,0-2,3

※ It can be changed for improving product's performance.

▶ One Cylinder Attachment



IMS200



IMD200



IMS300



IMD300



Model	Unit	IMS200	IMP200	IMD200	IMS300	IMP300	IMD300
Operating weight	kg	2,000	2,000	2,000	2,450	2,600	2,450
	lb	4,409	4,409	4,409	5,401	5,732	5,401
Overall Length	mm	2,181	2,386	2,321	2,174	2,627	2,529
	inch	85,87	93,94	91,37	85,59	103,43	99,57
Overall Width	mm	1,071	1,367	1,106	1,158	1,443	1,213
	inch	42,17	53,82	43,54	45,59	56,81	47,56
Max. Opening Width	mm	507	886	645	571	957	731
	inch	19,96	34,88	25,39	22,48	37,68	28,78
Cutter Length	mm	500	200	400	600	300	500
	inch	19,69	7,87	15,74	23,62	11,81	19,68
Crushing Force	ton(A)		53	61		73	82
	ton(B)		72			102	
	ton(C)		97			134	
	ton(D)		145			201	
Cutting Force	ton	172	165	172	256	229	256
	kg/cm ²		300			320	
Operating pressure	psi		4,226			4,550	
	LPM		200-250			250-300	
Oil Flow Rate	GPM		52,7-66,1			66,1-79,2	
	Suitable Excavator	ton		18-26			26-32
Speed Up Valve					Option		
Motor setting Pressure	kg/cm ²					160	
	psi					2,275	
Motor Oil Flow Rate	LPM					36-40	
	GPM					9,5-10,5	
Revolving Speed	RPM					13-15	

※ It can be changed for improving product's performance.

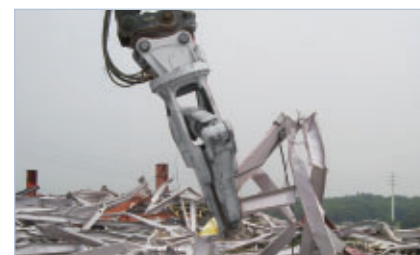

▶ Two Cylinder Attachment



IMS201



IMC201



IMP201



IMD201



Model	Unit	IMS201	IMC201	IMP201	IMD201
Operating weight	kg	1,760	1,680	1,760	1,760
	lb	3,880	3,704	3,880	3,880
Overall Length	mm	2,258	2,218	2,197	2,197
	inch	88,89	83,78	86,5	86,5
Overall Width	mm	1,294	1,354	1,541	1,541
	inch	50,94	53,31	60,67	60,67
Max. Opening Width	mm	522	886	872	872
	inch	20,55	34,88	34,33	34,33
Cutter Length	mm	120 x 4ea	180	180	180 x 2ea
	inch	4,72 x 4ea	7,09	7,09	7,09 x 2ea
Crushing Force	ton(A)	56	57	51	51
	ton(B)		85	61	
	ton(C)			78	
	ton(D)			95	
Cutting Force	ton(A)	73	183	183	183
	ton(B)	94			127
	ton(C)	127			
	ton(D)	200			
Operating pressure	kg/cm ²		300		
	psi		4,226		
Oil Flow Rate	LPM		200-250		
	GPM		52,8-66,1		
Suitable Excavator	ton		18-26		
Speed Up Valve				Option	
Motor setting Pressure	kg/cm ²				160
	psi				2,275
Motor Oil Flow Rate	LPM				36-40
	GPM				9,5-10,5
Revolving Speed	RPM				13-15

▶ Fixed Pulverizer



Model	IP150	IP200	IP250	IP300	IP500
weight	890	1500	1750	2350	4200
Opening with of jaw(mm)	0 - 800	0 - 870	0 - 980	0 - 1120	0 - 1280
Operating pressure(kg/cm ²)	260	280	300	300	300
Applicable Excavator(ton)	13 - 18	20 - 22	22 - 25	28 - 37	42 - 47

* This specification can be modified depends on the quality improvement etc.,

